



**RIPE NCC**

RIPE NETWORK COORDINATION CENTRE

# Technical Report

RIPE 79 - Rotterdam

Menno | RIPE79 Rotterdam | 18/10/2019

# Technical Team

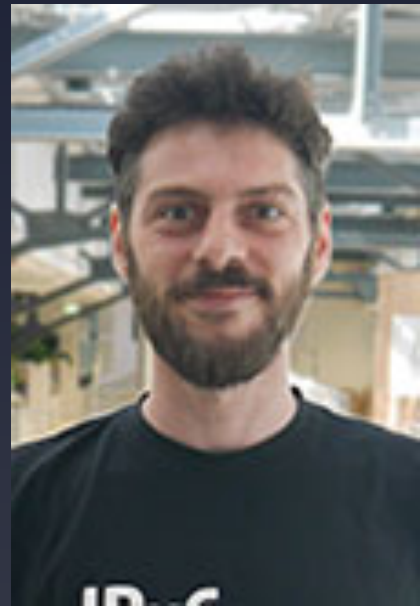

Andrea



Marco



Menno



Răzvan



Sjoerd



Xavier



# Technical Team

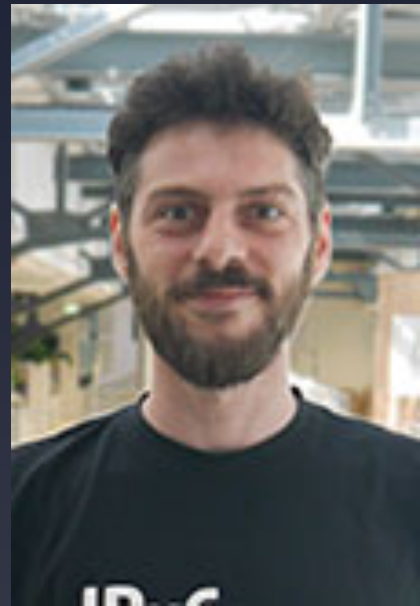

Andrea



Marco



Menno



Timour



Dave



Răzvan



Sjoerd



Xavier

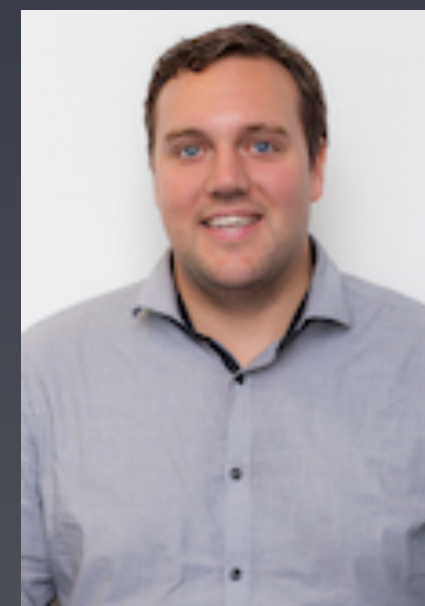

Rob

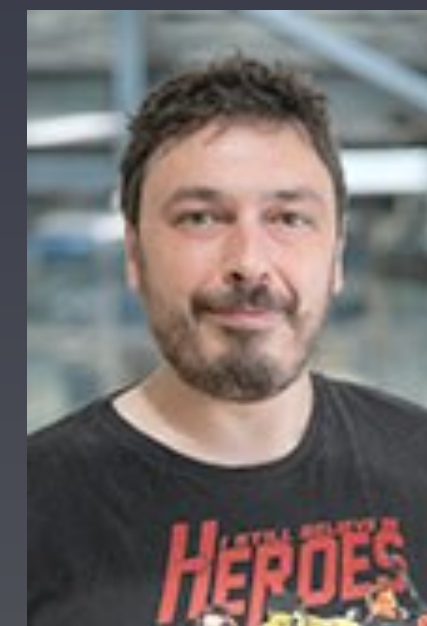

Davide

Extra help from colleagues on the Saturday





# Fiber cut at the WTC

- There was maintenance in the WTC
- Our fiber got cut because of this
- One week before the meeting!
- This was fixed quickly by our connectivity sponsor Eurofiber





# WiFi

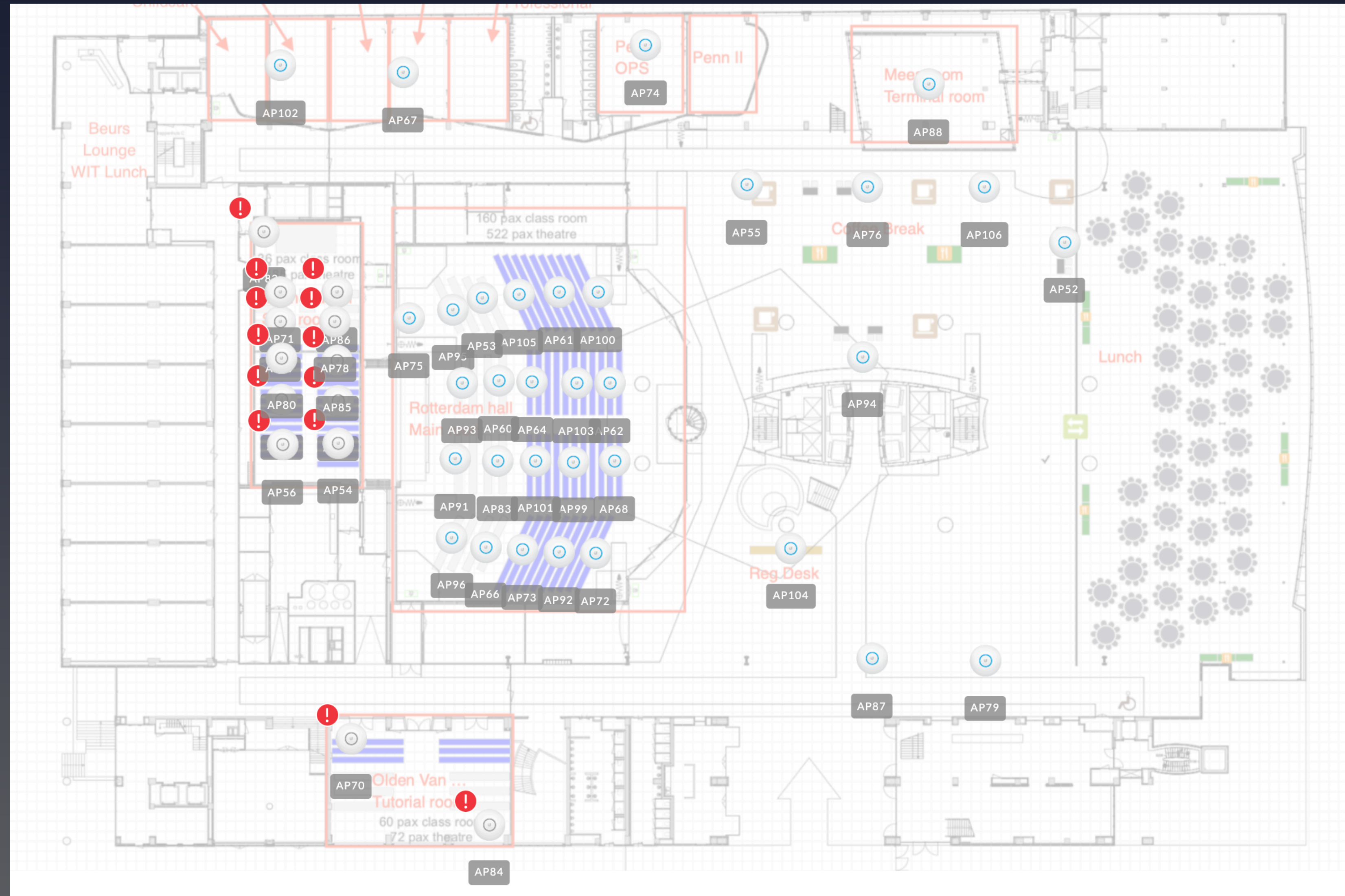



# Setup Weekend



- Making sure people get blinded
- Servers (all VM's)
- Switches and AP's
- Cabling and power
- Presentation system
- Webcast
- Limitimer
- And a lot more!



# FRRouting



- We moved from BIRD2 to FRR
- Everything works, also RPKI
- RPKI issue due to server reboot
- Somebody noticed and notified us through Twitter
- We will publish the configuration files here next week
- <https://gist.github.com/mschep>

# KEA DHCP



- Active-standby HA didn't perform well on Tuesday
- Multiple clients where offered the same IP address
- Not sure why this was happening
- Shutdown 1 of the 2 servers and all was good
- Still need to investigate what went wrong



# NAT64



- ipfw on FreeBSD
- s/ripemtg-nat64/ripemtg/ ?

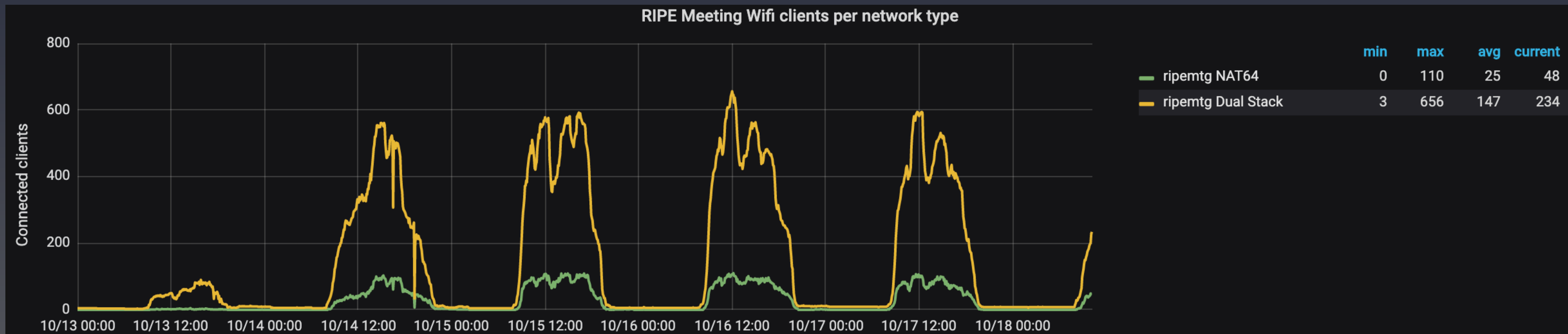



# Questions



[opsmtg@ripe.net](mailto:opsmtg@ripe.net)